

S Connector

Open new markets

THE VITOP CONNECTORS ENABLE YOU TO ENTER THE ON-TRADE MARKET.

The S Connector is designed to ensure clean, fast, economic, reliable and tight connections to pump or gravity distribution systems used in bars and restaurants.

It is extremely easy to undo and clean; the manipulation takes only a few seconds, which makes its use very simple and intuitive.

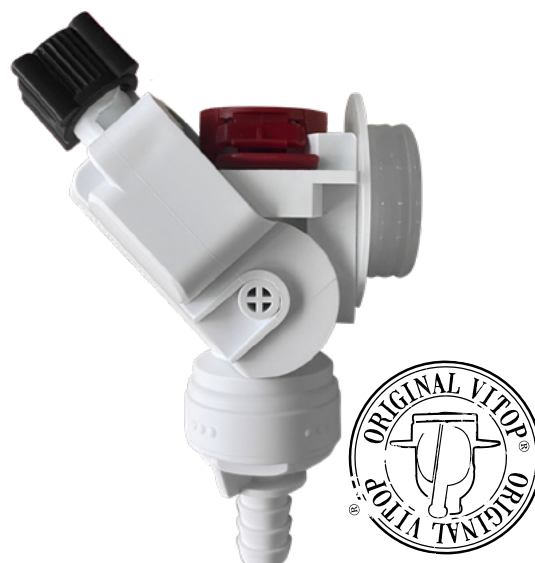

Benefits

Advantages of Vitop S Connector

- 1 **EASY TO USE:** The design of the S Connector is intuitive - it is easy to connect to the Original Vitop® tap, easy to undo and re-connect again.
- 2 **HYGIENE:** Cleaning is simple and quick and the S Connector is certified for food contact. It is fitted with an anti-return valve.
- 3 **FLEXIBILITY:** Several connector models are adapted to the application and the distribution system with T, L or standard shaped end fittings and end-fitting standard diameters of 6mm, 10 mm and 13 mm.
- 4 **COMPATIBILITY:** Guaranteed compatible with the Original Vitop®. Works with a pump and by gravity.



Please pay special attention to removing the tamper-proof seal prior to use. It is also important to place the Vitop tap fully into the connector before screwing down on the connector top wheel (which opens the tap mechanism).

Connecting the S Connector

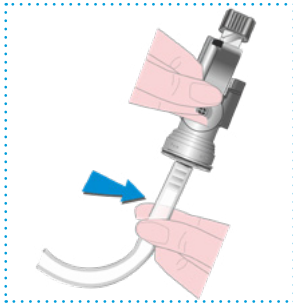

Place the tube on the connector

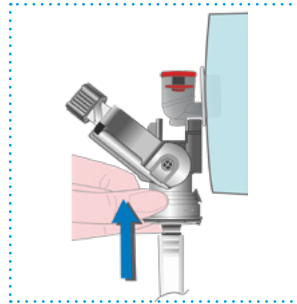

Place the tap inside the connector

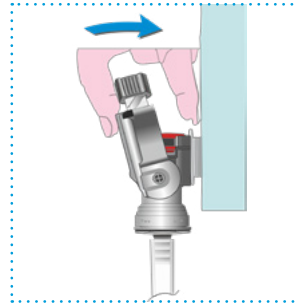

Push (pivot) to close the connector

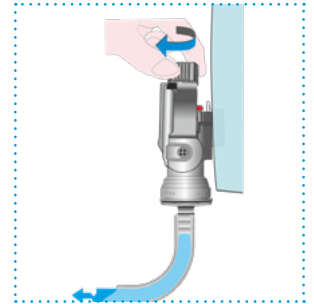

Screw the top button

Disconnecting the S Connector

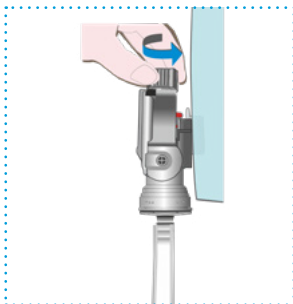

Open the connector

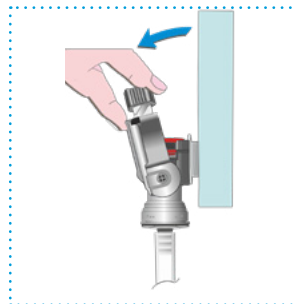

Pull (pivot) open the connector

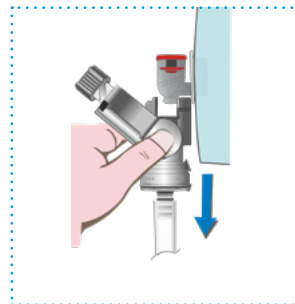

Remove the connector

Dismantling the S Connector

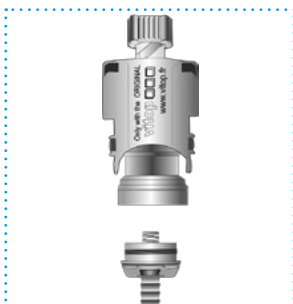

Unscrew the end-fitting

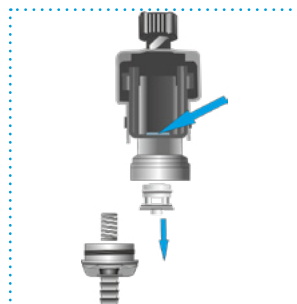

Apply pressure from above to remove the valve

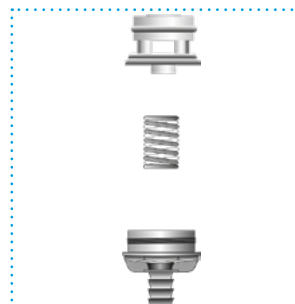

Clean the valve, spring and the connector body, if necessary

Reassembling the S Connector

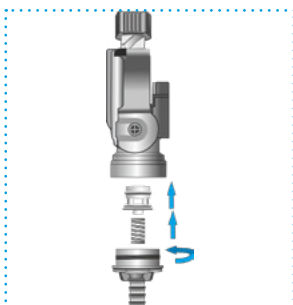

Replace the valve into the connector and the spring into the end-fitting

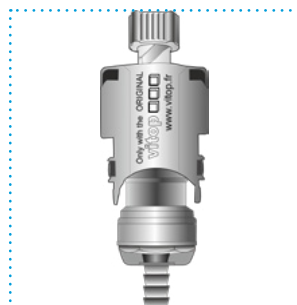

Assemble the connector
Screw tightly on the end-fitting

When putting the connector back together after cleaning, it is important to reseat the valve the right side up and to put back the spring.